

BIZINSIGHT FOR INTACCT 1.5.7.0

# Release Notes

BizInsight for Intacct 1.5.5 through 1.5.7.0  
December 5, 2016

## Copyright Notice

BizNet Software, Inc. makes no representations or warranties with respect to the contents of this document and specifically disclaims any implied warranties of merchantability or fitness for any particular purpose.

We welcome user comments and reserve the right to revise this publication and to make improvements or changes to the products and programs described in this publication at any time without notice.

### **Mailing Address:**

BizNet Software, Inc.  
14755 Preston Rd., Suite 800  
Dallas, TX 75254

### **Phone:**

1-888-803-5227

### **Web Site:**

[www.biznetsoftware.com](http://www.biznetsoftware.com)

© Copyright 2016 by BizNet Software, Inc. All rights reserved.

Printed in the United States of America

No part of this publication may be reproduced in any form without the prior written consent of BizNet Software, Inc.

## Trademarks

BizInsight is a registered trademark of BizNet Software, Inc.

Windows and Microsoft Excel are registered trademarks of Microsoft Corp.

All other trademarks are acknowledged.

## Table of Contents

<b>I. New Features.....</b>	<b>4</b>
1. Status Messaging .....	4
<b>II. Product Enhancements .....</b>	<b>5</b>
1. Service Caches Cleared .....	5
<b>III. Issues Resolved.....</b>	<b>6</b>
<b>IV. Known Issues .....</b>	<b>7</b>
<b>V. Best Practices .....</b>	<b>9</b>

# I. New Features

## 1. Status Messaging

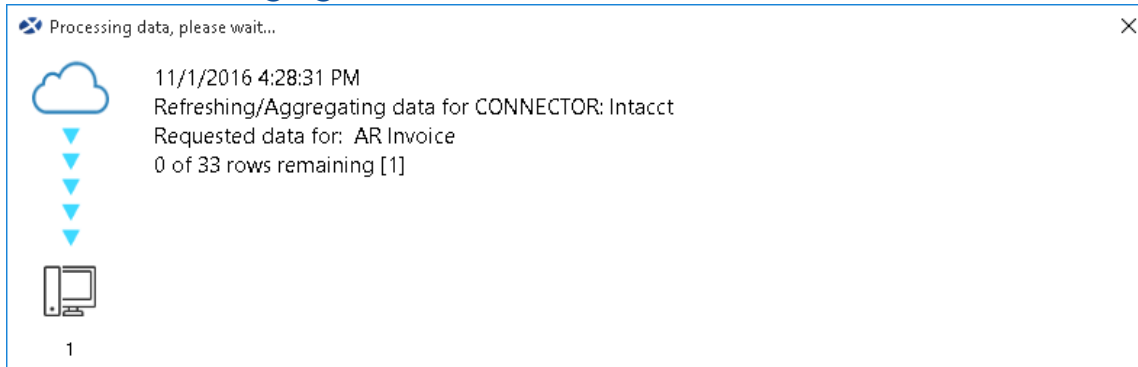

BizInsight 7 has been updated to provide status messages during data retrieval. The message includes the total rows, remaining record count, and time elapsed in seconds. This option is beneficial for users who may need to know the total record count for a particular large data table. Status messaging can be disabled in the BizInsight 7 Navigation Pane Settings Preferences menu.

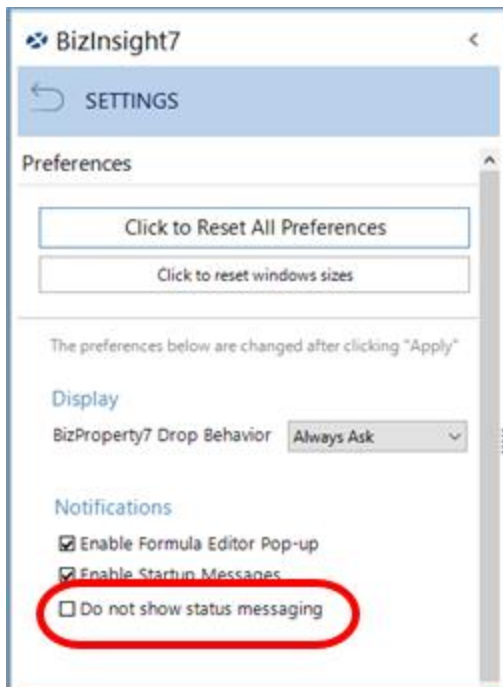

## II. Product Enhancements

### 1. Service Caches Cleared

When profiles are updated during the Configuration Wizard process, the caches in the Service is removed and cleared. This step is to prevent the re-use of cache associated to the previous profile.

### 2. Service Returns Zero-Row Data Sets

The Service returns a zero-row data table if no data exist in the data request. Previously, caches were not created if data was not retrieved. Functions in the report that used the same data cache would spend time trying to retrieve the same zero-row data set.

### 3. Service Timeout Expanded

The default timeout duration for receive, open, close, and send requests has been increased to 40 minutes.

## III. Issues Resolved

This release provides solutions for the following issues:

1. FEBK0000000069 – Updated TableSchema in various data sources to support the use of DateTime format.
2. FEBK0000000070 – Updated TableSchema in various data sources to support the use of Double format.
3. CAS-09307-Q0J3S1 – The IC Item table has a column for warehouse information but that column was not available in BizInsight. The product has been updated to include the warehouse information column.
4. CASE0000031700 – "When Posted" field has been added to the EEXPENSES table.
5. CASE0000034890 – Amounts returned by functions were doubled. The caching service is updated to rebuild the Ready Cache when the data set being updated contains a WhenModified column.

## IV. Known Issues

### 1. Reporting Periods without Start and End Dates

Intacct provides several system generated Reporting Periods that do not have Start and End dates, for example “Current Month”, “Next Month”, etc. Functions for which a Reporting Period parameter is required can only use Reporting Periods with Start and End Dates. Use the Reporting Periods table to identify usable Reporting Periods.

### 2. Selecting Data Headers

BizInsight Desktop Edition requires unique column headers to build tables and SuperFunctions into cache. Users are required to rename duplicate column headers.

### 3. Selecting a Table generated by BizInsight Desktop Edition

The Select Data capability requires users to be on the worksheet on which the data exists.

### 4. BizInsight Table Named Ranges

BizInsight Tables are automatically assigned Excel range names when created. Deleting the Table does not delete the assigned Excel range name and it will continue to display in the Select Data dialog until manually deleted.

### 5. Menu resizes in certain environments

In some tablet environments, or desktop environments that have text magnifier enabled (a display setting in Control Panel), BizInsight dialogs are not ideally sized and may have to be expanded to display all of their buttons. Once a user resizes a window, size selection will be preserved the next time the product is used.

### 6. Native Excel functions with SuperFunctions

Native Excel functions cannot be embedded in BizInsight Functions.

### 7. Column Header edits require Reselection

Editing local data cache column headers requires the data to be re-selected (using the **Select Data** button) in order for that data set to be usable by BizInsight Functions.

### 8. Formula Modifiers with BizInsight Functions.

Formula modifiers, such as “\*-1”, that are used with BizInsight Functions will not be represented in the BizInsight Query dialog when the Function is being edited. The formula modifier will be included when the Function is inserted into a cell.

### 9. Blank cells and Zeros

Blank cells are considered a null value, not a zero. This should be kept in mind when building parameters that are looking for zero values. If you have a column of numbers that have empty cells, you will want to populate these cells with zeroes before building filter





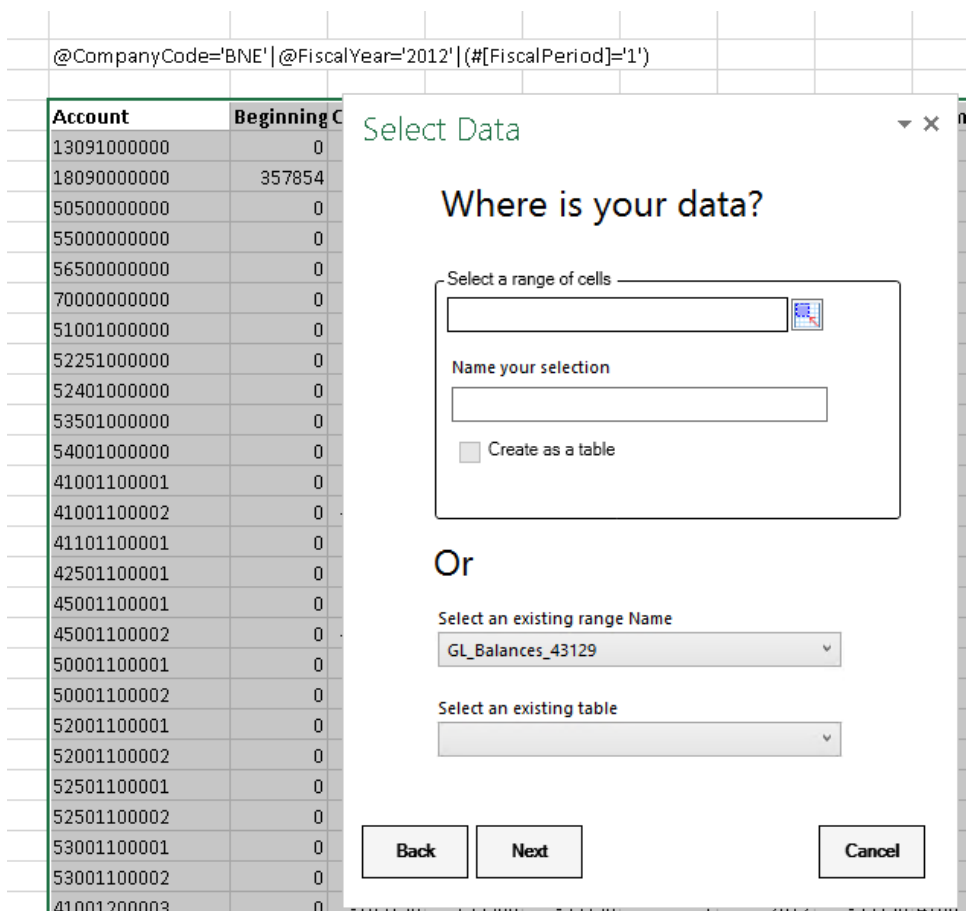

## V. Best Practices

### 1. Using Selected Excel Data

The product requires that you have a unique name for your data. Utilize a unique Range Name or Table Name across all workbooks in a single Excel session.

The product works best when you do not alter the Worksheet Name, Range Name, or Table Name used when selecting the data (**Select Data** button). However, if you decide to change the Worksheet Name, Range Name, or Table Name, the easiest way to make sure your data is updated successfully is to add the data again using the **Select Data** button on the ribbon.

If you decide to change the Worksheet Name, Range Name, or Table Name and do not re-add the data using the Select Data option, here are the exceptions to data synchronization:

- Renaming a Table Name or Range Name will cause the Cell Address to be used in place of the original name. If the renamed Table Name or Range Name is resized on refresh, the data will not be available in BizInsight.

- Renaming a Worksheet Name and then setting focus to another Worksheet will allow BizInsight to locate the renamed Worksheet. However, if you fail to set focus to another Worksheet after renaming the Worksheet, updated data will not be available in BizInsight.

Re-naming a workbook will not cause data synchronization failures.

## 2. Use of Named Ranges or Cell Ranges vs. Tables

Selecting Excel tables for use as a data source (as opposed to a range of cells or a named range) is best practice. With tables, deleting a row or column from a table that has been selected with the **Select Data** button will update the selection of data seen by the product. This feature is not supported with cell ranges and only partially supported with the use of named ranges (for example, adding rows or columns to the outer edge of a named range is not supported).

## 3. Working with Dates, Times, and DateTimes

When working with data that is either a Date, Time, or DateTime data type, it is important for users to format the cells containing that data accordingly. Cells containing date values should be formatted as Date, cells containing time values should be formatted as Time, and cells containing a date and a time should be formatted with a custom format that contains both date and time (i.e. “mm/dd/yyyy hh:mm:ss AM/PM”).